

excite<sup>OSA</sup>

## User Guide

**IMPORTANT SAFEGUARDS:  
READ ALL INSTRUCTIONS BEFORE USE**

---

# Contents

Important safeguards .....	3
What's in the box? .....	6
Intended use.....	8
eXciteOSA smartphone application .....	8
Using your eXciteOSA with a smartphone application .....	12
My eXciteOSA phone application .....	14
Frequency of usage .....	18
Charging the control unit.....	18
Storing & travelling with your eXciteOSA.....	19
Washing .....	19
Settings.....	20
Frequently asked questions .....	22
Trouble shooting .....	25
eXciteOSA system, operational requirements.....	26
eXciteOSA system, transport and storage requirements .....	26
Symbols used .....	28
Specifications.....	29
Declarations .....	32
Table A: Representative output with varying loads.....	34

---

# Important safeguards

## READ ALL INSTRUCTIONS BEFORE USE.

(for latest User Guide, please refer to <https://exciteosa.com>)

### WARNINGS

To avoid the risk of electrocution, burns, fire or physical injury:

- The device is only to be used **while awake**. It should not be used while sleeping.
- Only the supplied products should be used together. Do not use attachments other than those recommended by the manufacturer.
- Discontinue use if the product appears damaged in any way.
- Never attach the Mouthpiece directly to a charging source other than the control unit provided.
- This device should only be charged using the USB Cable provided.
- Do not operate in close proximity (e.g. 3.4 feet) to a shortwave or microwave unit as other Electromagnetic equipment may produce instability in the simulator output.
- Always keep the Control Unit away from water.
- Unplug the Control Unit immediately if it falls into water.
- Never use a damaged USB Cable to charge the Control Unit.
- This product contains no user serviceable parts. Refer to “Warranty” and “Trouble Shooting” if appliance no longer works as expected.
- The device is only to be used as specified in this document.

## READ ALL INSTRUCTIONS BEFORE USE.

### WARNINGS

To avoid the risk of physical injury:

- This device should not be used by persons:
  - children (under 18 years of age)
- eXciteOSA should be kept away from children and pets (choking hazard and electrical hazard).
- eXciteOSA to be used in a home or healthcare environment (or equivalent).
- eXciteOSA is a single person device and should not be shared or used by other individuals.
- Do not use eXciteOSA when driving a vehicle or operating machinery and other equipment.
- When charging the device, keep away from all liquids.
- No modification of this device is allowed. Do not try to alter, trim or change any components of the device.
- The silicon on the Mouthpiece must be intact before use. If there is any breach of the silicon (including electrodes) - **DO NOT USE THE MOUTHPIECE.**

## READ ALL INSTRUCTIONS BEFORE USE.

### CONTRAINDICATIONS

#### Do not Use eXciteOSA if:

- you are pregnant or maybe pregnant
- you have a pace maker or implanted electrodes
- you have dental braces or jewellery in your mouth.
- you are suffering from mouth ulceration or recent dental work.
- having or suspecting of having obstructive sleep apnoea with AHI greater than 15.

**Safety and effectiveness in the above conditions have not been established.**

### PRECAUTIONS

#### Consult your Doctor/Dentist if:

- you have gum disease or have bleeding from your gums or other oral conditions.
- you experience pain, numbness or bleeding after using this product.
- you have any nose, throat conditions and previous oral surgery
- you have any medical conditions
  - Facial skeletal abnormalities
  - Obesity (BMI > 35)

#### This device should not be used:

- while asleep (device only to be used when **awake**)
- in contact with your head, neck, spine, chest, eyes, ears or any other parts of the body other than inside the mouth as instructed.

#### Adverse Reactions:

- accumulation of saliva
- tingling sensation on tongue

# What's in the box?

eXciteOSA package includes:

1

Mouthpiece (Top view)

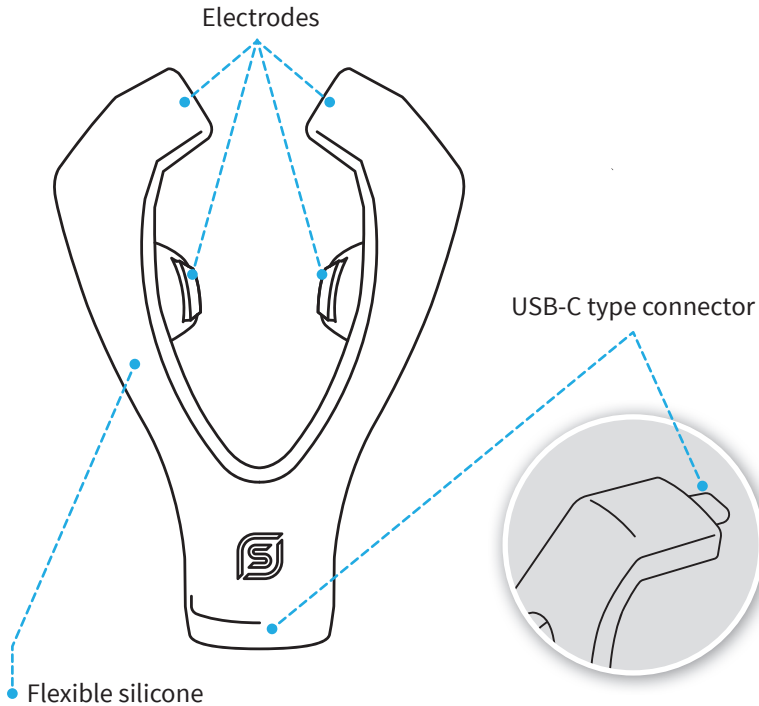

Fig.1

2

## Control Unit (With Bluetooth)

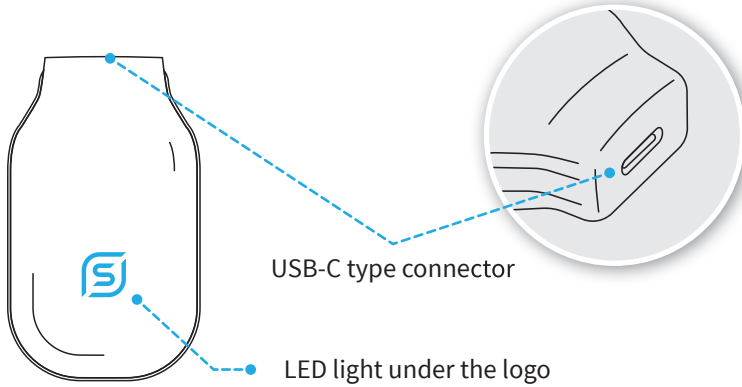

Fig.2

3

## USB Cable and adapter (15cm cable and included adapter)

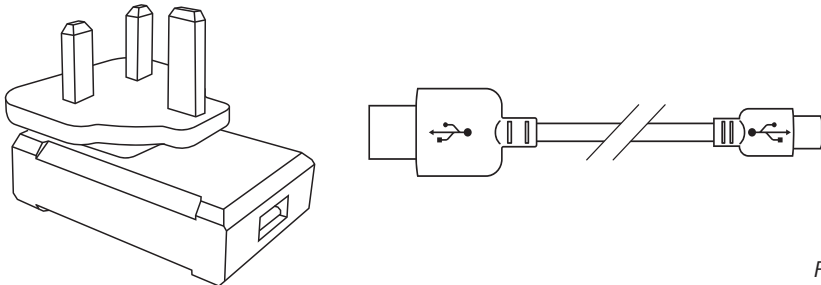

Fig.3

# Intended use

eXciteOSA is intended for the reduction of snoring and obstructive sleep apnoea by strengthening tongue muscles via electrical muscle stimulation.

**INDICATIONS FOR USE:** eXciteOSA is indicated for use to reduce snoring and mild sleep apnoea (AHI<15) for patients that are 18 years or older.

## eXciteOSA smartphone application

eXciteOSA device can be controlled by eXciteOSA Smartphone application. Smartphone application can be downloaded from App Store (Apple iOS) or Play Store (Google Android).

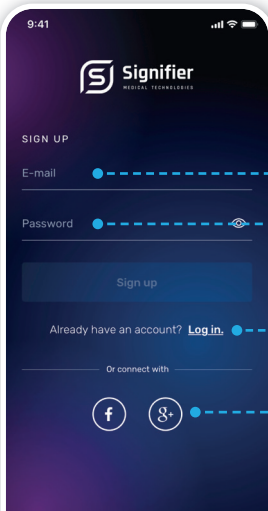

### LOG IN & SIGN UP

The log in & sign up section allows you to authenticate or create an account.

#### SIGN UP

- Enter the e-mail you want to register with
- Enter a secure password (minimum 6 characters)
- If you are already registered you can login here
- You can sign up with one of these services  
*(this will require authentication on the appropriate external service)*



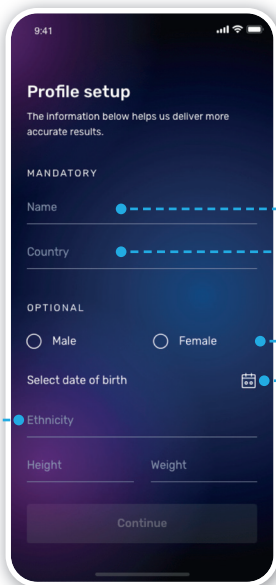

## PROFILE SET UP

Enter your full name

Enter your country of residence

Select your gender

Select your date of birth

Enter your ethnicity, height and weight\*

*\* Your data is always safe with us. You can check our Privacy policy, on our website <https://exciteosa.com/privacy-policy>, for further details.*

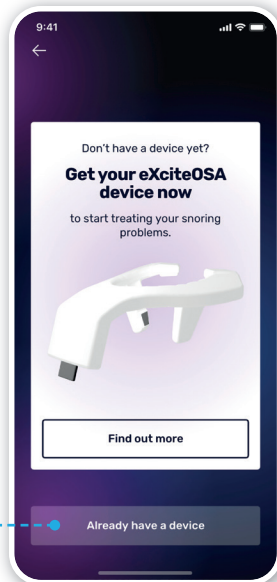

Select whether you already have a eXciteOSA device or not.

*If you choose yes, additional setup is required.*

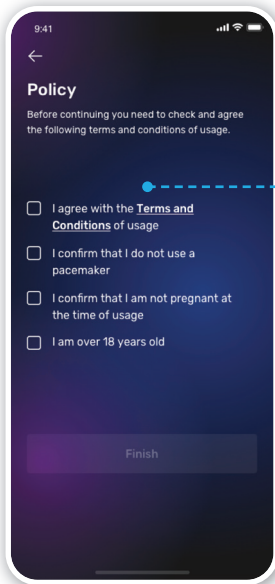

## POLICY

There are a number of terms you have to agree to in order to use the eXciteOSA device with the mobile app.

First, make sure you read the Terms and Conditions page, and agree with them.

Next, please confirm that you do not use a pacemaker and that you are not pregnant. **It is very important that none of these apply to you as the eXciteOSA device can interfere with your pacemaker or with your baby's development.**

Also, you have to be a legal adult.

## LOG IN

Enter your registered e-mail and password

If you forgot your password, tap here. You will receive an e-mail with further instructions.

You can log in with one of these services *(this will require authentication on the appropriate external service)*

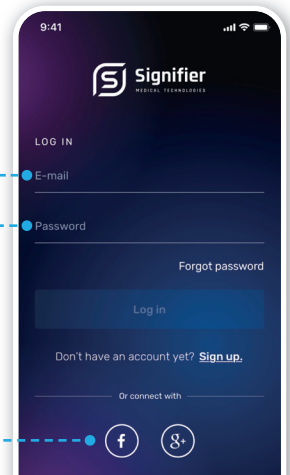

# THE DASHBOARD

The dashboard is the main screen of the app where all the features are available from.

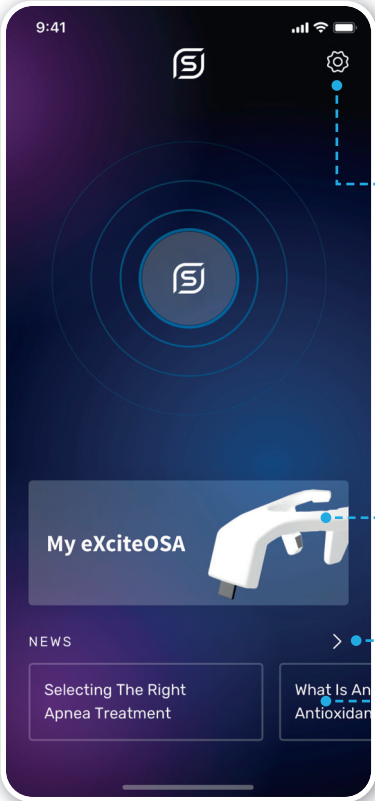

- Settings
- eXciteOSA therapy
- Educational content
- Articles

## Using your eXciteOSA with a smartphone application

Before starting your therapy be sure to: check the silicon on the Mouthpiece is not cracked or broken before use. If there is any evidence of damage to the silicon - **DO NOT USE THE MOUTHPIECE.**

Before use, wash the Mouthpiece with cold and running potable tap water as shown in Fig 4. Avoid water reaching the USB port. Dry with clean towel.

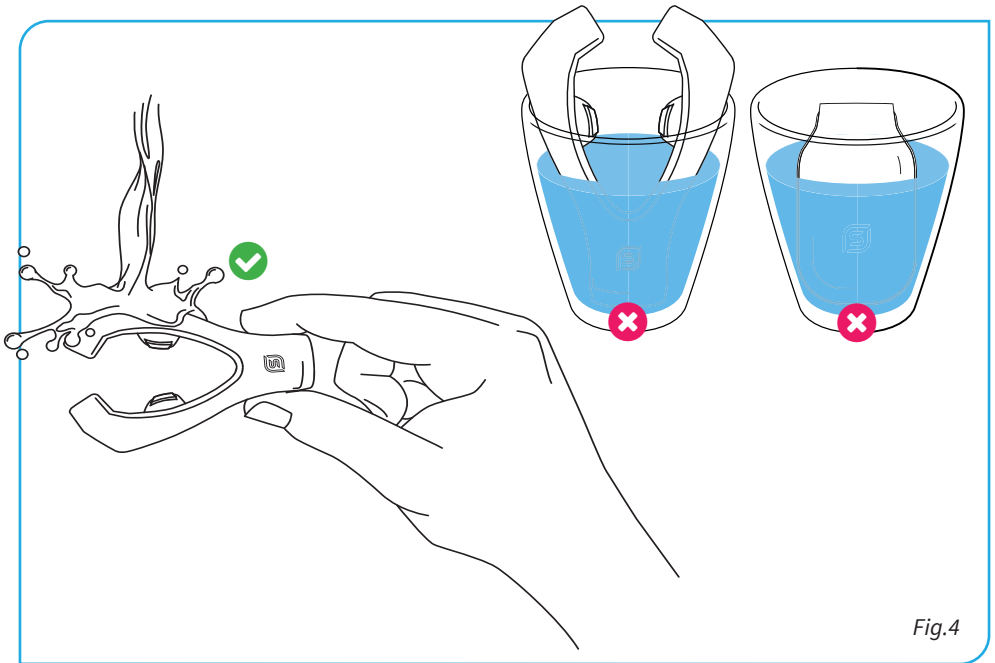
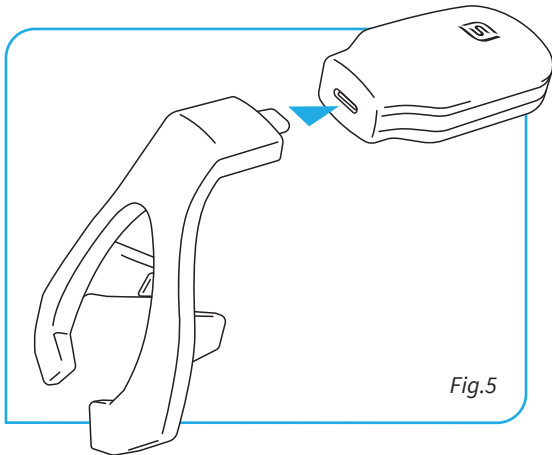

Fig.4



To start using eXciteOSA, connect the Mouthpiece with the Control Unit as shown on Fig 5.

Fig.5

Figure 6

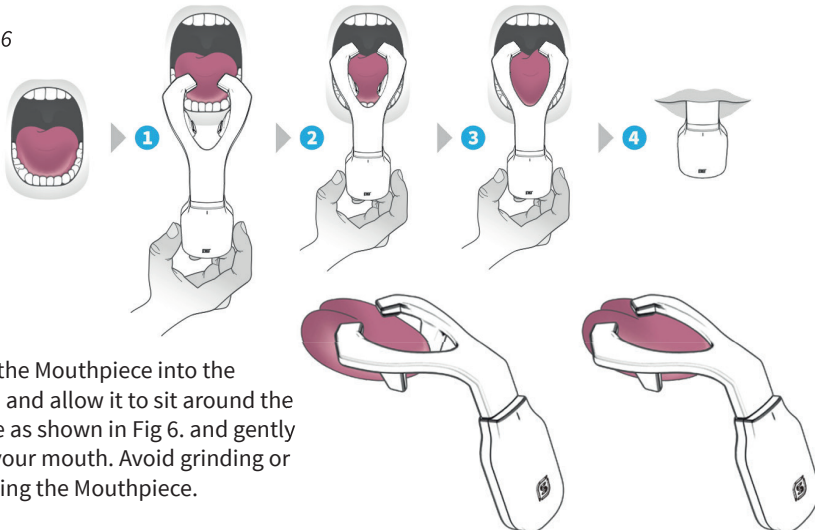

Insert the Mouthpiece into the mouth and allow it to sit around the tongue as shown in Fig 6. and gently close your mouth. Avoid grinding or clenching the Mouthpiece.

# My eXciteOSA phone application

My eXciteOSA is the place where you can start your eXciteOSA therapy or add your device.

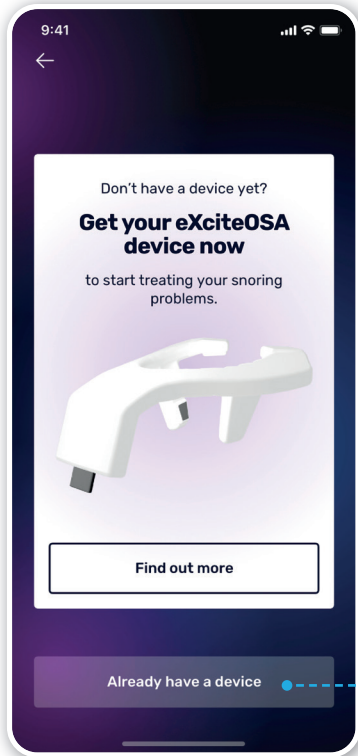

Add a eXciteOSA device  
*(make sure that the device is nearby)*

This screen will appear if you haven't already added a device.

**In order for the eXciteOSA device to work, you need to allow Bluetooth connection.**  
For iOS 13 or above you need to manually allow Bluetooth permission.

Before starting your therapy be sure to: check your device for cracks or broken parts, connect the controller to the mouthpiece, insert the mouthpiece into the mouth.



## CONNECT

In order to start the therapy, you need to pair your phone with the control unit. Please make sure that the control unit is close to your phone.

## REMOTE CONTROL

Indicates if the device is connected to the phone

Indicates the device battery status

Indicates the remaining time of the therapy

Pauses the therapy

Stops the therapy

Therapy intensity controller  
(you can choose between 15 levels; please wait a couple of seconds before the new setting takes effect)

Reading mode/Newsletter

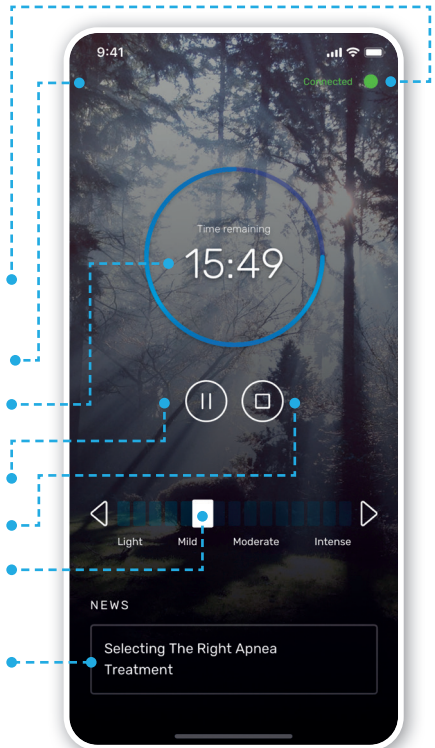

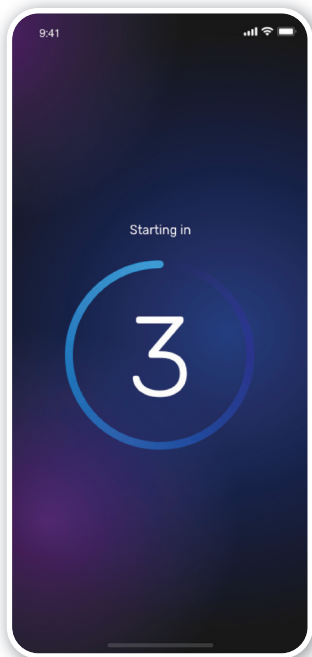

## COUNTDOWN

After pairing your eXciteOSA device with your mobile phone, your therapy will start with a countdown from 3 to 1 before initiating the actual therapy.

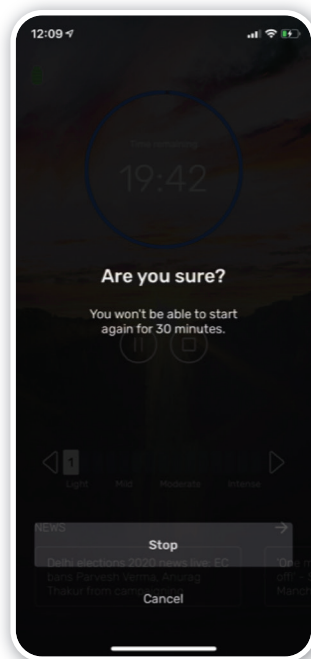

## STOP THERAPY

Therapy can be stopped at any time but due to safety reasons it can only be restarted after 30 minutes after the device has been stopped or the therapy has ended. Keep this in mind when stopping the therapy.



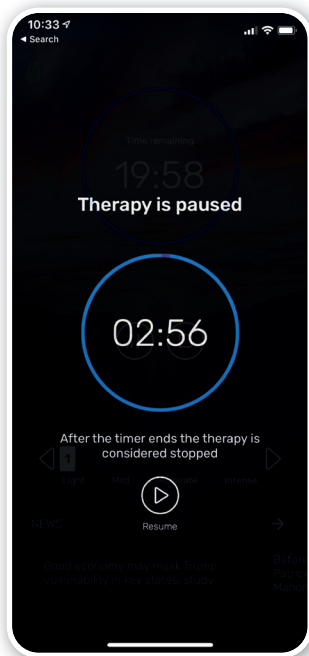

## PAUSE THERAPY

Therapy can be paused at any time. It can be paused only for 3 minutes. After the 3 minutes have passed the therapy is considered stopped and can only be restarted after 30 minutes.

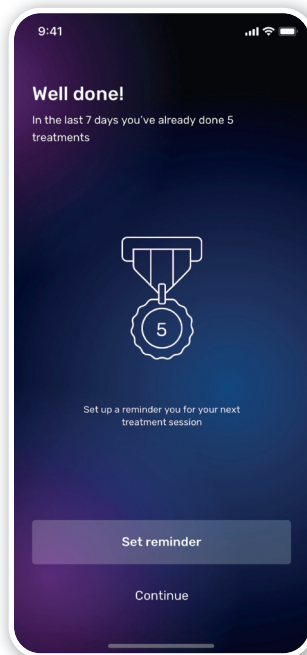

## SET A REMINDER

You can set a reminder at a specific time each day, so that you don't miss your therapy.

## END OF THERAPY SESSION

Therapy can be paused at any time. It can be paused only for 3 minutes. After the 3 minutes have passed the therapy is considered stopped and can only be restarted after 30 minutes.

## Frequency of usage

It is recommended you use eXciteOSA once daily for a continuous 20 minutes. It can take up to 6 weeks of daily therapy before you will gain the desired improvement in your mild OSA or snoring. After 6 weeks of therapy, only two, 20-minute sessions are required each week thereafter. eXciteOSA can be used long term. This is comparable to maintaining your physical fitness by undertaking regular exercise.

You are recommended to replace the Mouthpiece after **three months** of first use, which includes the maintenance period.

## Charging the control unit

Before using the device for the first time, you must charge the battery for at least 2 hours. The Control Unit LED will flash blue and amber if there is inadequate charge to run a full 20 minute therapy session. When Control Unit logo (Fig 8) blinks blue and amber, recharge the Control Unit. To charge the Control Unit, use the USB Cable provided and connect the Control Unit jack into a USB power adapter. During charging, the eXciteOSA logo will blink. When fully charged, the eXciteOSA logo will become continuous blue.

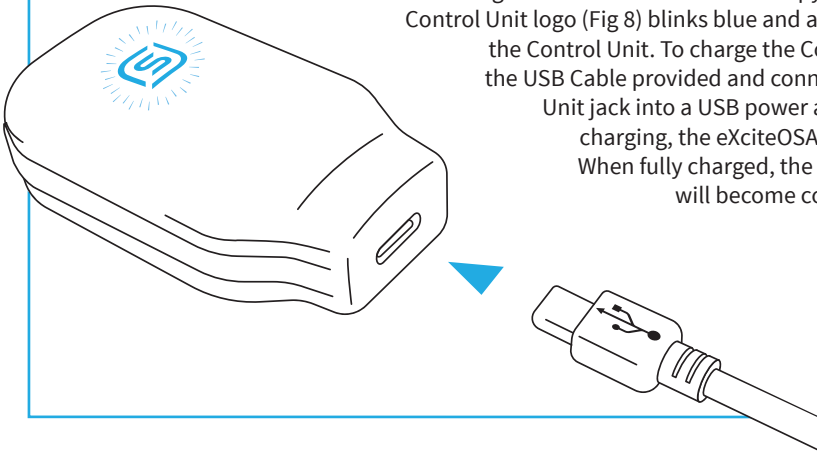

Fig.8

---

# Storing & travelling with your eXciteOSA

## **MOUTHPIECE**

Once the Mouthpiece has been washed in potable tap water and dried, it can be stored in its storage stand. The Mouthpiece is packaged in a removal stand which can be used for storage or regular stand for the Mouthpiece.

## **CONTROL UNIT**

The Control Unit must be kept dry throughout its use and storage. After use, store in a dry environment or the storage box. If you plan to travel with your eXciteOSA, place each unit in its original packaging to protect during transportation.

---

# Washing

## **MOUTHPIECE**

The Mouthpiece should be washed before and after each use. Use potable, running tap water to wash the Mouthpiece. Dry with a clean towel and store in a dry place. **DO NOT** wash with alcohol based cleaning solutions.

## **CONTROL UNIT**

Wipe the Control Unit surface with a damp cloth or antiseptic wipe once a week. **DO NOT** immerse the Control Unit in water or cleaning solutions. Always store the Control Unit in a dry place.

# Settings

Manage all of your settings from a single place.

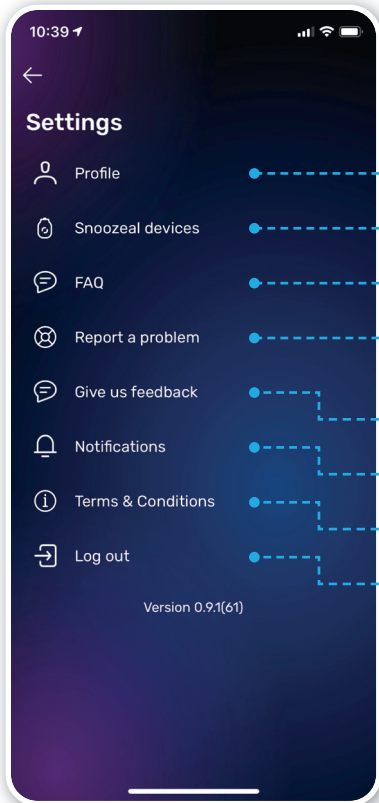

See and edit you profile

A list of your devices

A list of frequently asked questions

Had a problem with the app or device?  
You can report it here.

Feedback make us improve the product

Manage your notifications settings

All legal matters can be found here

Log out of your account

## SEE/EDIT PROFILE

Change any of the data already provided and then tap 'Save', to save your changes.

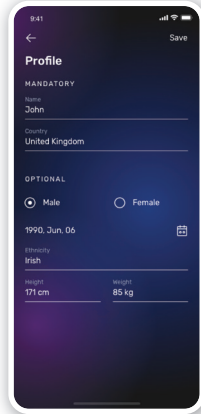

## FAQ

Check the Frequent Asked Questions to see answers for your problems.

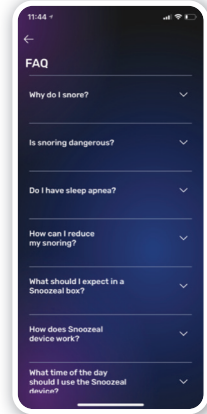

## REPORT A PROBLEM

Did anything go wrong with the app or the device? Describe the problem and let us know. We'll try to solve it and take the appropriate measures.

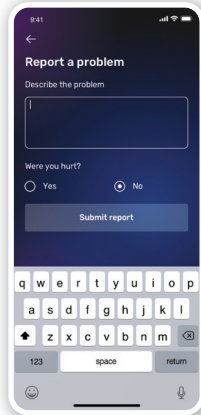

## NOTIFICATIONS

Change the time of your notifications. Enable or disable them, so that you can have a smoother experience.

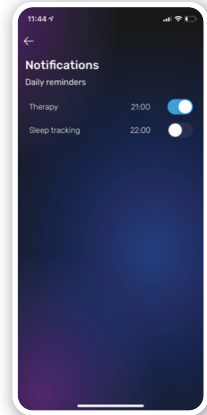

---

# Frequently asked questions

## **Why do I snore?**

Snoring is caused by vibration of the structures of the throat during sleep. When you sleep, the muscles of the throat relax and partially collapse. The narrowest parts of the throat can then create turbulence of the air flowing through your throat which makes the snoring sound

You're more likely to snore if you:

- are overweight
- drink too much alcohol
- smoke
- sleep on your back

## **Is snoring dangerous?**

It has been shown that Snoring affects sleep quality of the snorer and partner. It is important to note that snoring may just be the tip of the iceberg. Although snoring per say does not damage your health, Snoring can be a clue to a more serious condition called obstructive sleep apnoea (intermittent complete blockage of breathing during sleep).

## **Do I have sleep apnoea?**

Sleep apnoea is a serious health condition associated with health problems like high blood pressure and increased risks of heart attack, stroke, or death. It is often associated with day time sleepiness and your partner may notice you breath hold or stop breathing in the night.

If you have these symptoms or are concerned you may have the condition, please refer to your doctor.

### **How does eXciteOSA device work?**

The eXciteOSA device will deliver small electric currents through the Mouthpiece to your tongue, this will stimulate the tongue muscle and improve its tone. The improved tone of the tongue muscle will help in keeping the breathing passage open during your sleep and reduce the vibration of the throat region.

### **How soon do I see the result with eXciteOSA?**

You should notice an improvement in your snoring within 4 weeks. This is dependent upon adherence to the recommended therapy programme of one 20 minute session daily. Although you may see improvement within 4 weeks, we recommend you finish the 6 week therapy period to ensure you gain the optimal improvement possible.

### **At what level should I start and what is the optimum level for my therapy?**

The intensity always starts at level 1; it is recommended that you increase the intensity to a level that is comfortable for you for each therapy session. The therapy changes frequencies at 5 minute intervals. At these intervals the stimulation will automatically drop in intensity for comfort. If you feel any discomfort or lack of stimulation, then the intensity can be reduced or increased accordingly. Over the duration of the recommended therapy programme you will notice that your tolerance levels will increase, and you can go up in intensity comfortably. It is important to avoid increasing the intensity to beyond comfortable level, as higher intensity will not lead to additional improvement.

**What should I expect during and after my therapy?**

During the therapy you should experience a tingling sensation on the tongue and tongue muscle contractions. As the intensity is increased the muscle contraction will get stronger. Please remember to set the intensity at a level that is comfortable for you. Increasing the intensity beyond comfortable level will not improve the outcome of the therapy session. It may become an uncomfortable sensation.

**What time of the day should I use the eXciteOSA device?**

The eXciteOSA can be used anytime during the day, but it is recommended to be used before you go to sleep at night.



---

## Trouble shooting

The Control Unit powers up but the Mouthpiece does not work:

- Check the Control Unit has adequate power to run a 20 minutes therapy session
- Check there is no fluid ingress within the USB connector
- Check there is no damage to the mini USB connector
- Check there is no damage to the Mouthpiece
- If the above steps have been implemented, then contact the eXciteOSA's Help/Support team

## eXciteOSA system, operational requirements

Temperature +41°F to +104°F (+5°C to +40°C)

Humidity 15% to 90%

Atmospheric Pressure 10.15 psi to 15.37 psi (70 kPa to 106 kPa)

Operational life is 3 years.

## eXciteOSA system, transport and storage requirements

Temperature -13°F to +158°F (-25°C to +70°C)

Up to 90%

Atmospheric Pressure 10.15 psi to 15.37 psi (70 kPa to 106 kPa)

When the device is exposed to extreme temperatures, please wait at least 60 minutes before attempting to use the device.

## **DISPOSAL**

Please return the products to your supplier for disposal. The Control Unit contains a rechargeable battery and should not be disposed in general waste.

## **FAULTS & REPAIRS**

eXciteOSA should be used in accordance with this User Guide above and with the approved accessories and contains no user serviceable parts. Do not try to repair, alter or change the components of the three individual units of the eXciteOSA, as this will invalidate your warranty. If the Mouthpiece or Control Unit is not functional due to wear and tear, it will not be covered by the warranty. The Mouthpiece is recommended to be replaced after 3 months of first use.

## **WARRANTY**

Signifier Medical Technologies Ltd. provides a warranty to the original purchaser confirming the product will be free from defects in the material, components and workmanship for a period of 3 months for the Mouthpiece and 1 year (Control Unit only) from the date of purchase. For valid warranty claims, the user may return after authorisation, the eXciteOSA directly to the local eXciteOSA contact or Signifier Medical Technologies Ltd. eXciteOSA warranty does not include any misuse or abuse such as dropping or immersing the Control Unit in water or other liquid substance or tampering with the unit or normal wear and tear. Any evidence of tampering will void the warranty. This warranty does not apply to “wear and tear” that would occur with usage.

## **CUSTOMER SERVICE**

Please contact your local Signifier Medical Technologies contact for any warranty returns. Your invoice of purchase should state the name and the contact details of your local Signifier Medical Technologies contact. For assistance in setting up, using or maintaining the unit, or to report unexpected operation or events please contact Signifier Medical Technologies customer service.

# Symbols used



Refer to instructions manual



Storage Temperature Limits



Catalogue number



Keep dry



Serial number



Non Sterile



Manufacturer



Type BF applied part



Date of manufacture



WEE directive

# Specifications

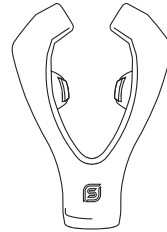

	Control Unit	Mouthpiece
Colour	White and Blue	White and Grey
Packaging	eXciteOSA is packed in a protective box package	
Power source	Rechargeable 100mAh LiPo cell	N/A
Max output voltage	32.4 V Output varies with impedance (see Table A on page ??)	
Max output current	70mA Output varies with impedance (see Table A on page ??)	
Output signal	100us/phase (Bi-Phasic output) Up to 20 Hz	
Operating temperature	From +41°F to +104°F (+5°C to +40°C)	
Storage temperature	-13°F to +158°F (-25°C to +70°C)	
Atmospheric Pressure Range	10.15 psi to 15.37 psi (70 kPa to 106 kPa)	
Humidity	Relative Humidity 20% to 85%	Relative Humidity up to 100%
Degree of Protection	Control Unit ( IP44) (IP 44 - Protection protected against objects > 1 ml and splashing water, IP42 - Protection protected against objects > 1 ml and dripping water) IP 64 - Mouthpiece (Protection against dust and splashing water) IP67 - Mouthpiece (Protection against dust and temporary immersion in water)	
Mode of operation	ON/OFF	

Radio Frequency Information	Control Unit
Frequency Band Of Reception	2.4 GHz to 2.48 GHz
The Bandwidth of The Receiving Section in Those Bands	2 MHz
Effective Radiated Power	up to 3.5 dBm

## IEC 60601-1-2:2014 (EDITION 4) / EN 60601-1-2:2015 (Home healthcare environment)

Standard	Category		
CISPR 11 / EN 55011	Emissions	Radiated Emissions (30 - 1000 MHz)	Class B
CISPR 11 / EN 55011	Emissions	Conducted Emissions	N/A
IEC/EN 61000-3-2	Emissions	Harmonic Current Emissions	N/A
IEC/EN 61000-3-3	Emissions	Voltage Fluctuations and Flicker	N/A
RTCA/DO160G	Emissions	Radiated Emissions (100 MHz - 6 GHz)	Section 21 Category M
ANSI C63.4, FCC CRF 15.209 / ICES-003	Emissions	Radiated Emissions (30 MHz - 12.5 GHz)	Class B
IEC/EN 61000-4-2	Immunity	Electrostatic Discharge Immunity	Air: 2,4,8,15kV. Contact: 8kV
IEC/EN 61000-4-3	Immunity	Radiated RF Immunity	10 V/m: 80 MHz to 2.7 GHz. 3 V/m: 2.7 GHz to 6 GHz
IEC/EN 61000-4-3 / IEC/EN 61000-4-39	Immunity	Immunity to Proximity fields from RF wireless communications equipment	385 MHz 27 V/m 450 MHz 28 V/m 710, 745, 780 MHz 9 V/m 810, 870, 930 MHz 28 V/m 1720, 1845, 1970, 2450 MHz 28 V/m 5240, 5500, 5785 MHz 9 V/m
IEC/EN 61000-4-4	Immunity	Electrical Fast Transients Immunity	N/A
IEC/EN 61000-4-5	Immunity	Voltage Surge Immunity	N/A
IEC/EN 61000-4-6	Immunity	Conducted RF Immunity	N/A
IEC/EN 61000-4-8	Immunity	Power Frequency Magnetic Field Immunity	N/A
IEC/EN 61000-4-11	Immunity	Voltage Dips and Short Interruptions Immunity	100 % reduction for Half Cycle 30 % reduction for 25/30 Cycles 100 % reduction for 1 Cycle >95 % reduction for 250/300 Cycles

**WARNING:**

- Use of this equipment adjacent to or stacked with other equipment should be avoided because it could result in improper operation. If such use is necessary, this equipment and the other equipment should be observed to verify that they are operating normally.
- Use of accessories, transducers and cables other than those specified or provided by the manufacturer of this equipment could result in increased electromagnetic emissions or decreased electromagnetic immunity of this equipment and result in improper operation.
- Portable RF communications equipment (including peripherals such as antenna cables and external antennas) should be used no closer than 30 cm (12 inches) to any part of the eXciteOSA System, including cables specified by the manufacturer. Otherwise, degradation of the performance of this equipment could result.

**If the eXciteOSA system is exposed to EM disturbance, there should not be any loss or degradation to performance. However the performance should be monitored for the accuracy of waveform.**

---

# Declarations

## **FOR USA**

FCC warning statement:

This device complies with Part 15 of the FCC Rules.

- Operation is subject to the following two conditions:
  1. This device may not cause harmful interference, and
  2. This device must accept any interference received, including interference that may cause undesired operation.
- This equipment complies with FCC radiation exposure limits set forth for an uncontrolled environment. End users must follow the specific operating instructions for satisfying RF exposure compliance. This transmitter must not be co-located or operating in conjunction with any other antenna or transmitter.
- Changes or modifications not expressly approved by the party responsible for compliance could void the user's authority to operate the equipment

## **FOR CANADA**

*"This device complies with Industry Canada's licence-exempt RSSs. Operation is subject to the following two conditions:*

- 1. This device may not cause interference; and*
- 2. This device must accept any interference, including interference that may cause undesired operation of the device."*

Please see Section 8.4 of RSS-Gen Issue 4 for further information.



**Signifier Medical Technologies Limited**

The Triangle, 6th Floor, Hammersmith Grove, Hammersmith,  
London, W6 0LG, UK

Email: [info@signifiermedical.com](mailto:info@signifiermedical.com)  
[www.exciteosa.com](http://www.exciteosa.com)

**Distributed in the USA by**

Signifier Medical Technologies LLC  
175 Highland Avenue Needham MA 02492

+1844 MILDOSA (+1844 645 3672)

**EC REP**

Advena Ltd. Tower Business Centre, 2<sup>nd</sup> Flr., Tower Street,  
Swatar, BKR 4013 Malta

**This product is Manufactured by Signifier Medical Technologies**

in compliance with Medical Device Standards and Quality Standards: ISO 13485:2016

# Table A: Representative output with varying loads

Mouthpiece load	900 Ohm		500 Ohm		338 Ohm	
Therapy level	Measured Voltage (V)	Calculated current (mA)	Measured Voltage (V)	Calculated current (mA)	Measured Voltage (V)	Calculated current (mA)
1	2.21	2.46	1.67	3.34	1.34	3.96
2	4.6	5.11	3.46	6.92	2.59	7.66
3	6.7	7.44	5.31	10.62	3.74	11.07
4	8.06	8.96	6.91	13.82	5.6	16.57
5	10.9	12.11	9.1	18.2	6.6	19.53
6	12.6	14	10.7	21.4	7.8	23.08
7	14.7	16.33	12.3	24.6	9.1	26.92
8	17.3	19.22	14.1	28.2	10.4	30.77
9	19.5	21.67	17.9	35.8	11.4	33.73
10	21.4	23.78	20.2	40.4	12.5	36.98
11	23.4	26	21.8	43.6	13.8	40.83
12	25.3	28.11	23.7	47.4	15.2	44.97
13	27.2	30.22	25	50	16.5	48.82
14	28.8	32	26.6	53.2	17.3	51.18
15	29.8	33.11	28.5	57	19.8	58.58



**Signifier**

MEDICAL TECHNOLOGIES



1282

User Guide English: 045300003 Dated October 2021